

THE DRAWINGS AND INFORMATION CONTAINED HEREIN ARE THE EXCLUSIVE PROPERTY OF ACTEL. THE INFORMATION AND DESIGN CONCEPTS CONTAINED HEREIN ARE CONFIDENTIAL AND PROPRIETARY. SHALL BE MAINTAINED IN STRICT CONFIDENCE AND SHALL NOT BE RELEASED TO ANY THIRD PARTY WITHOUT THE EXPRESS WRITTEN PERMISSION OF ACTEL.

REV. NO.	REV.	DESCRIPTION OF CHANGE	EFFECTIVE DATE	ORIGINATOR
980379	0	Initial	12/15/98	R. Kuang

Applicable [C] Dimension (important dimensions)

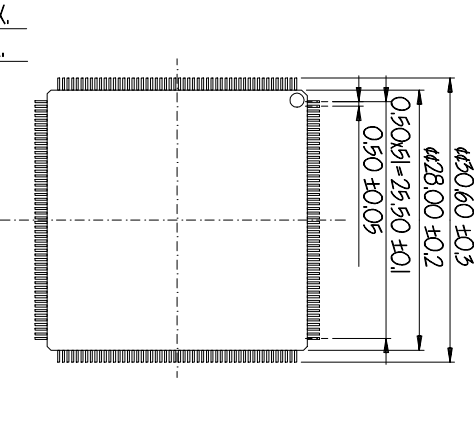

Recommended PCB layout

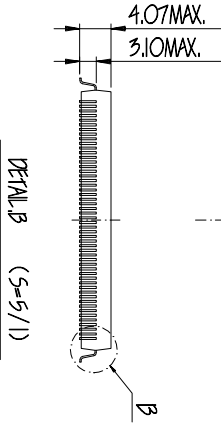
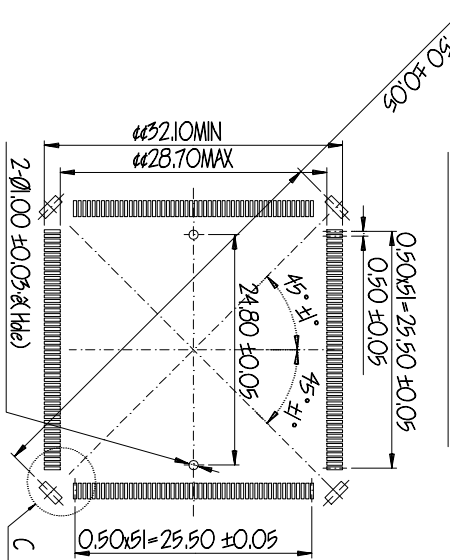

DETAIL C (5-5/1)

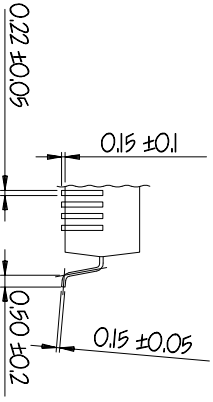
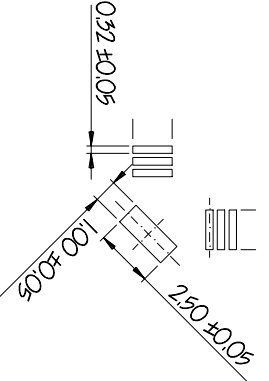

ACTEL CONFIDENTIAL

UNLESS OTHERWISE SPECIFIED DIMENSIONS ARE IN MILLIMETERS	ANGULAR ±1°
DECIMAL	
X.X ±0.10	
X.XX ±0.05	
X.XXX ±0.03	
MATERIAL	SEE NOTES
FINISH	SEE NOTES
DO NOT SCALE DRAWING	

PRODUCTION	
APPROVALS	
DRAWN	R. Kuang
CHECKED	
DATE	10/9/98

TITLE	ACTEL CORP 955 E ARQUES AVE SUNNYVALE, CA 94086
TITLE	Yamatchi PQ208 Surface Mount Socket-w/alignment pin
SIZE	B
VENDOR	Yamatchi
VENDOR PART NUMBER	IC149-208-161-SS
ACTEL DWG NUMBER	N/A
VENDOR DWG NUMBER	
SCALE	NONE
SHEET	2 OF 2