

THE DRAWINGS AND INFORMATION CONTAINED HEREIN ARE THE EXCLUSIVE PROPERTY OF ACTTEL. THE INFORMATION, DRAWINGS AND DESIGN CONCEPTS CONTAINED HEREIN ARE CONFIDENTIAL/PROPRIETARY, SHALL BE MAINTAINED IN STRICT CONFIDENCE, AND SHALL NOT BE RELEASED TO ANY THIRD PARTY WITHOUT THE EXPRESS WRITTEN PERMISSION OF ACTTEL.

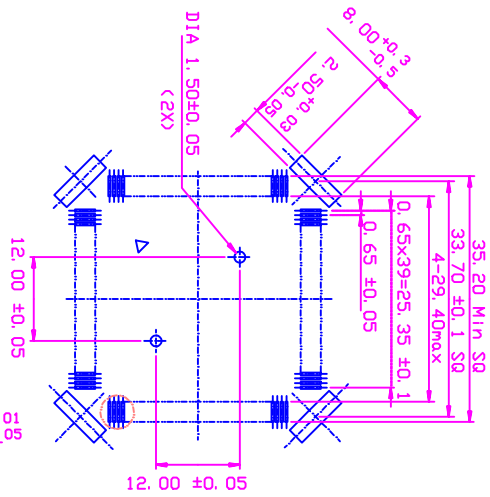
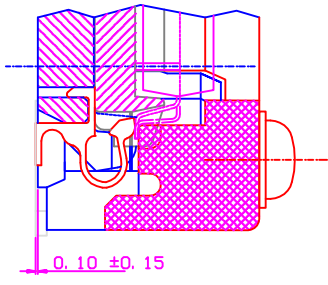
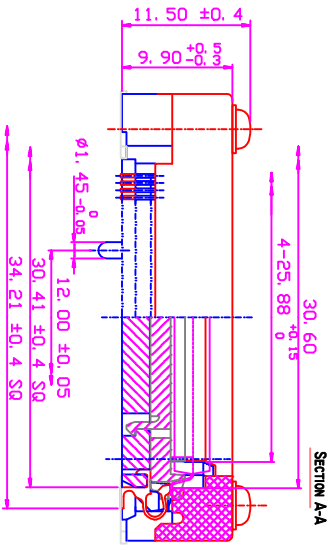
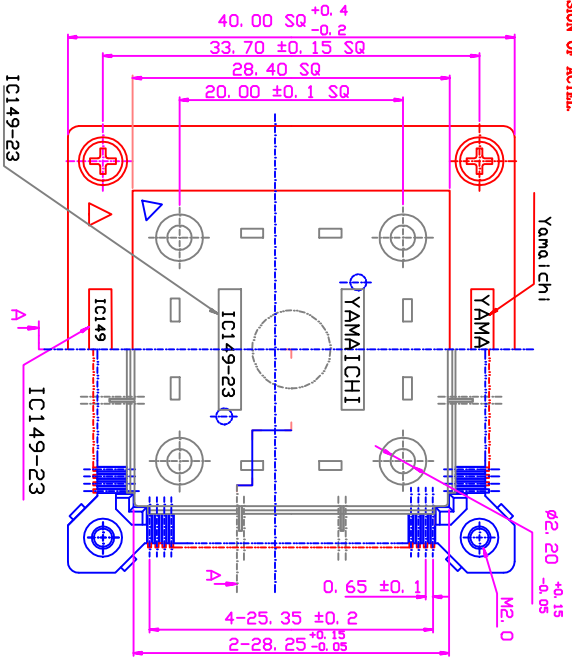

Recommended PCB Layout

- Notes:
- Controlling dimensions are in millimeters.
  - Yamaichi socket number ICI49-160-123-S5

ITEM NO.	REV.	DESCRIPTION OF CHANGE	APPROXIMATE DATE	ORGANIZATION
980379	0	Initial	12/15/98	Kuang

UNLESS OTHERWISE SPECIFIED DIMENSIONS ARE IN MILLIMETERS

DECIMAL XX ±0.05  
 ANGULAR XXXX ±0.09  
 FINISH SEE NOTES  
 DO NOT SCALE DRAWING

PRODUCTION		APPROVALS		DATE		TITLE	
DRAWN	R. Kuang	10/21/98				Yamaichi Pq160	Surface Mount Socket--alignment pins
CHECKED						Yamaichi	ACTTEL DWG. NUMBER 1-07-09031
ENG'G						Yamaichi	YAMAICHI DWG. NUMBER N/A
RELEASED						Acttel Part#:	SY-PQ160-1

ACTTEL CONFIDENTIAL